

# Kodak 1000

## Intraoral Video Camera

### **Greater accuracy. Better patient care.**

The Kodak 1000 intraoral video camera (formerly the Trophy STV Pro 2) helps you to share accurate images of your patients' dental anatomy to provide them with a higher level of service and a greater understanding of the treatment options. This precision tool enhances patient communication and offers high-resolution images for precise diagnoses.

### **Superb image quality.**

The single camera features all functions to capture macros, intraoral views, the complete arch, smiles and portraits. The macro mode (x60) can display details that are invisible to the naked eye. Equipped with a high resolution CCD and a 4-point halogen light, your images are clear, precise and have excellent color quality for the utmost in patient communication.

### **Improved ergonomics and greater comfort.**

The Kodak 1000 camera is strong, lightweight, hygienic and easy to hold. Its ergonomics, refined design and medical steel finish make it perfect to handle and maintain. All views are instantly at your fingertips without any optical changes being required. The light comes on automatically and adapts to varying lighting conditions.

### **Scalable, portable and economic.**

The camera can be easily integrated in the operating area, placed where you need it and is always available for use. And the new Kodak docking station makes it easy to share the camera between several operatories.



### **An all purpose camera:**

- Intraoral and extraoral views
- Image freezing and saving
- Direct and mirror vision
- Can be used on a computer or video monitor



# Quality images, satisfied patients.

## Educate. Explain. Convince.

Everyone knows that a good picture speaks a thousand words. Images from the Kodak 1000 camera can help you reassure, educate and build better relationships with your patients. Showing your patients images can help gain treatment acceptance and improve patient satisfaction. The camera also helps convey a modern and professional snapshot of your practice.

## Integrate images into your practice.

It is essential to capture an accurate image and also use it and share it to improve patient care. Simple pressure on the floor pedal freezes images which are then saved by the Kodak dental imaging software if the camera is linked to a computer. Images can then be easily integrated into patient files, used to simulate cosmetic treatment or be sent to colleagues.

## Reliable services and support.

At Kodak, we're committed to providing the ongoing guidance and support you need to get the most out of your Kodak 1000 camera. We are ready to help you integrate your camera into your practice and are available to answer your questions and provide quality after-sale support.



## TECHNICAL SPECIFICATIONS

### Kodak 1000 QuickShare docking station:

- Video standard: PAL or NTSC, Connection USB 2, S-Video or composite video
- "Intelligent Portrait" mode: automatic variable shutter speed
- Mirror mode: yes

### Camera:

- Diameter of endoscope: 11 mm
- Magnification: x 60
- Light: halogen integrated in the hand piece
- Field of vision: 72°
- Visual angle: 90° single optical system (intra and extra oral)
- Cable length: 2.5 m

With the Kodak 1000 docking station you can easily move and share the camera between workstations.

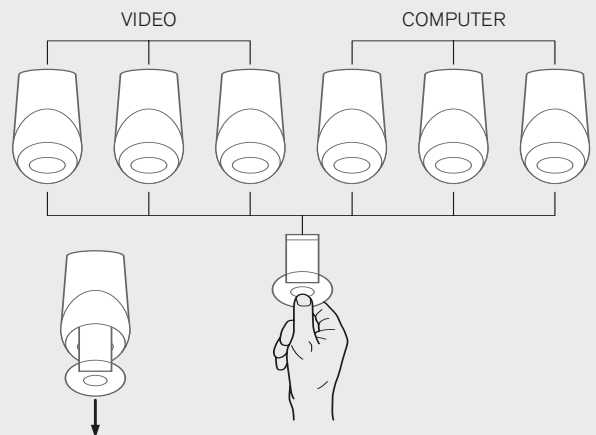

© Eastman Kodak Company 2004.  
Kodak, Trophy and STV are trademarks  
of Eastman Kodak Company.

**KODAK INFOLINE**  
**Free phone** – United Kingdom: 0800 89 51 13 - Ireland: 1800 55 49 97  
Denmark: 800 171 49 - Norway: 800 11 167  
Other countries: +49 (711) 406-3910 - Greece: (01) 689 8620  
or visit: [www.kodak.com/dental](http://www.kodak.com/dental)